

**NATIONAL REGISTER OF HISTORIC PLACES
INVENTORY - NOMINATION FORM**

(Type all entries - complete applicable sections)

STATE: North Carolina	
COUNTY: Lincoln	
FOR NPS USE ONLY	
ENTRY NUMBER	DATE
MAR 24 1974	

1. NAME	
COMMON: Shadow Lawn	
AND/OR HISTORIC:	

2. LOCATION			
STREET AND NUMBER: 301 West Main Street			
CITY OR TOWN: Lincolnton (Ninth Congressional District, The Hon. Charles R. Jonas)			
STATE North Carolina	CODE 37	COUNTY: Lincoln	CODE 109

3. CLASSIFICATION			
CATEGORY (Check One)	OWNERSHIP	STATUS	ACCESSIBLE TO THE PUBLIC
<input type="checkbox"/> District <input type="checkbox"/> Site <input type="checkbox"/> Object <input checked="" type="checkbox"/> Building <input type="checkbox"/> Structure	<input type="checkbox"/> Public <input checked="" type="checkbox"/> Private <input type="checkbox"/> Both Public Acquisition: <input type="checkbox"/> In Process <input type="checkbox"/> Being Considered	<input checked="" type="checkbox"/> Occupied <input type="checkbox"/> Unoccupied <input type="checkbox"/> Preservation work in progress	Yes: <input type="checkbox"/> Restricted <input type="checkbox"/> Unrestricted <input checked="" type="checkbox"/> No
PRESENT USE (Check One or More as Appropriate)			
<input type="checkbox"/> Agricultural <input type="checkbox"/> Commercial <input type="checkbox"/> Educational <input type="checkbox"/> Entertainment	<input type="checkbox"/> Government <input type="checkbox"/> Industrial <input type="checkbox"/> Military <input type="checkbox"/> Museum	<input type="checkbox"/> Park <input checked="" type="checkbox"/> Private Residence <input type="checkbox"/> Religious <input type="checkbox"/> Scientific	<input type="checkbox"/> Transportation <input type="checkbox"/> Other (Specify) Comments DEC 28 1971 NATIONAL REGISTER

4. OWNER OF PROPERTY			
OWNER'S NAME: Charles R. Jonas			
STREET AND NUMBER: 301 West Main Street			
CITY OR TOWN: Lincolnton	STATE: North Carolina	CODE 37	

5. LOCATION OF LEGAL DESCRIPTION			
COURTHOUSE, REGISTRY OF DEEDS, ETC.: Lincoln County Courthouse			
STREET AND NUMBER:			
CITY OR TOWN: Lincolnton	STATE: North Carolina	CODE 37	

6. REPRESENTATION IN EXISTING SURVEYS			
TITLE OF SURVEY:			
DATE OF SURVEY:	<input type="checkbox"/> Federal	<input type="checkbox"/> State	<input type="checkbox"/> County <input type="checkbox"/> Local
DEPOSITORY FOR SURVEY RECORDS:			
STREET AND NUMBER:			
CITY OR TOWN:	STATE:	CODE	

SEE INSTRUCTIONS

STATE: North Carolina	COUNTY: Lincoln	ENTRY NUMBER MAR 24 1974	DATE
FOR NPS USE ONLY			

7. DESCRIPTION

CONDITION	(Check One)					(Check One)
	<input checked="" type="checkbox"/> Excellent	<input type="checkbox"/> Good	<input type="checkbox"/> Fair	<input type="checkbox"/> Deteriorated	<input type="checkbox"/> Ruins	
	(Check One)		(Check One)			
	<input checked="" type="checkbox"/> Altered	<input type="checkbox"/> Unaltered	<input type="checkbox"/> Moved	<input checked="" type="checkbox"/> Original Site		

DESCRIBE THE PRESENT AND ORIGINAL (if known) PHYSICAL APPEARANCE

Shadow Lawn, situated directly on Main Street in Lincolnton, North Carolina, is a large two-story brick mansion, five bays in width and two bays in length with a gable roof. The structure is raised on a full basement whose high water table is indicated by a three-course stringer which is repeated as a dividing band between the first and second stories. Both courses break out around the exterior end chimneys, one located on the east side and two on the west. The chimneys, like the walls, are laid in Flemish bond and have single-stepped shoulders and molded caps. The handsome cornice at the front and rear, formed of molded brick in alternating concave and convex courses, is an unusually fine example of its type, a standard feature on brick houses of Lincoln County during this period. On the gutter box at each upper corner of the main facade is the date "1826."

The central entrance of the main (north) facade and of the rear consists of a raised-paneled door beneath a transom. The molded architrave and four-light transom of the rear entrance are original, but the front doorway with a pediment supported by plain pilasters is new. The double transverse brick entrance stair, with an open arch beneath the landing, is a recent addition also. The original arrangement was probably a simple stoop. The windows of both stories have nine-over-nine sash, although the first-story windows are taller and narrower than those of the second story. All are framed by fluted architraves and surmounted by flat arches. The basement is lit by large windows protected by wrought-iron grilles. Entrance to the basement is gained through a door in the south bay of the west side. Flanking the east chimney at the first and second levels are nine-over-six sash windows, and in the gable, six-pane lights. The west chimneys are flanked by narrow six-over-six sash windows at each level, and a single six-pane gable window between the two stacks. A one-story frame addition has eliminated the first-story window in the south bay.

The plan of Shadow Lawn, consisting of a central hall flanked by a single east room and two west rooms, is intact, although little of the original interior trim remains at the first level. The original molded chair rail and baseboard remain, but the flat-paneled dados and dentil cornices in the first rooms were added in the twentieth century. The balustrade of the open-string stair, which rises against the east wall of the hall, has a molded, ramped handrail above slender turned balusters, and terminates in a scrolled newel. A plain plaster transverse arch located at the rear of the stair divides the front and rear halls. Mantels were originally present in each room; the only one that remains in the first floor is that in the northwest dining room. This tall mantel in the Federal style is composed of a wide flat-paneled frieze with a central tablet below a delicate molded shelf supported by slender flat-paneled pilasters. A heavy molded architrave surrounds the rectangular fireplace opening.

The interiors at the second level remain essentially intact with plaster walls accented by molded cornices, chair rails, and baseboards. The mantels are quite simple, each consisting of a molded architrave around the rectangular opening and unadorned frieze below the molded cornice shelf.

SEE INSTRUCTIONS

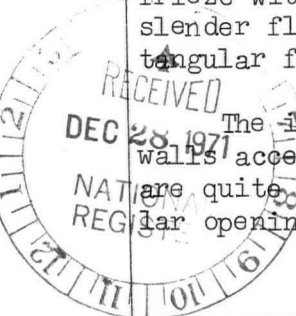

8. SIGNIFICANCE

PERIOD (Check One or More as Appropriate)

☐ Pre-Columbian

☐ 16th Century

☐ 18th Century

☐ 20th Century

☐ 15th Century

☐ 17th Century

☒ 19th Century

SPECIFIC DATE(S) (If Applicable and Known)

AREAS OF SIGNIFICANCE (Check One or More as Appropriate)

☐ Aboriginal

☐ Education

☐ Political

☐ Urban Planning

☐ Prehistoric

☐ Engineering

☐ Religion/Phi-

☐ Other (Specify)

☐ Historic

☐ Industry

losophy

☐ Agriculture

☐ Invention

☐ Science

☒ Architecture

☐ Landscape

☐ Sculpture

☐ Art

☐ Architecture

☐ Social/Human-

☐ Commerce

☐ Literature

itarian

☐ Communications

☐ Military

☐ Theater

☐ Conservation

☐ Music

☐ Transportation

STATEMENT OF SIGNIFICANCE

In 1825 Paul Kiestler [sic] bought lot number eight located in the southwest square of the town plan of Lincolnton from Abner McAfee. The next year he built the substantial brick house that stands on that lot, at the corner of Main and High streets. The date, 1826, is inscribed on two gutter boxes on the house. Paul Kistler (as the name is more commonly spelled), a successful businessman, died in 1848 at the age of sixty-six, leaving "one half of the house and lot I live in" to each of his two sons, Lawson H. and Robert, after the death of their mother. Robert did not survive his mother, and Lawson died in 1868 intestate, leaving minor children with no guardian. To settle the estate, the court appointed J. H. King commissioner to sell the Kistler house, which he did on April 7, 1871, to Augustus Pinkney James, who had served in the Mexican War.

The property remained in the James family until it was sold to Charles Raper Jonas and his wife, Annie Elliott Jonas, on July 8, 1935. The Jonas family, who renovated and made some additions to the house, named the house Shadow Lawn. Jonas, a native of Lincolnton, has been a North Carolina representative in the House from the 83rd through 92nd congresses.

Shadow Lawn represents the architectural idiom which is characteristic of the finer Federal houses built in Lincoln County in the early nineteenth century. These structures possess almost no ornamentation. Their distinction is derived from the fine quality of building materials and workmanship and the simple clarity of the construction. Shadow Lawn is one of the few structures remaining of this type built in an urban environment, and its restraint and containment are eminently suitable in this setting. It is also notable for its thirty-six-year association with Charles R. Jonas. A notable Republican in a predominantly Democratic state, Jonas has served continuously in the United States House of Representatives since 1953.



SEE INSTRUCTIONS

9. MAJOR BIBLIOGRAPHICAL REFERENCES

Lincoln County Records, Lincoln County Courthouse, Lincolnton, North Carolina, Office of the Register of Deeds. (Subgroups: Deeds, Wills, and Estate Papers).

Lincoln County Records, State Department of Archives and History, Raleigh, North Carolina. (Subgroups: Deeds, Wills, and Estate Papers).

Henderson, Archibald, and Wootten, Bayard. Old Homes and Gardens of North Carolina. Chapel Hill: The University of North Carolina Press (published under the auspices of the Garden Club of North Carolina), 1939.

10. GEOGRAPHICAL DATA

LATITUDE AND LONGITUDE COORDINATES DEFINING A RECTANGLE LOCATING THE PROPERTY			LATITUDE AND LONGITUDE COORDINATES DEFINING THE CENTER POINT OF A PROPERTY OF LESS THAN TEN ACRES		
CORNER	LATITUDE	LONGITUDE			
	Degrees Minutes Seconds	Degrees Minutes Seconds	Degrees	Minutes	Seconds
NW	° ' "	° ' "	35°	28'	14"
NE	° ' "	° ' "	81°	15'	40"
SE	° ' "	° ' "			
SW	° ' "	° ' "			

APPROXIMATE ACREAGE OF NOMINATED PROPERTY: 1/4 Acre

LIST ALL STATES AND COUNTIES FOR PROPERTIES OVERLAPPING STATE OR COUNTY BOUNDARIES

STATE:	CODE	COUNTY	CODE
STATE:	CODE	COUNTY:	CODE
STATE:	CODE	COUNTY:	CODE
STATE:	CODE	COUNTY:	CODE

11. FORM PREPARED BY

NAME AND TITLE: Survey and Planning Unit Staff, John B. Wells, III, Supervisor

ORGANIZATION: State Department of Archives and History DATE: 8 December 1971

STREET AND NUMBER: 109 East Jones Street

CITY OR TOWN: Raleigh STATE: North Carolina CODE: 37

12. STATE LIAISON OFFICER CERTIFICATION

NATIONAL REGISTER VERIFICATION

As the designated State Liaison Officer for the National Historic Preservation Act of 1966 (Public Law 89-665), I hereby nominate this property for inclusion in the National Register and certify that it has been evaluated according to the criteria and procedures set forth by the National Park Service. The recommended level of significance of this nomination is:

National ☐ State ☒ Local ☐

Name H. G. Jones

Title Director, State Department of Archives and History

Date 8 December 1971

I hereby certify that this property is included in the National Register.

Ernest A. Connally
Chief, Office of Archeology and Historic Preservation

Date DEC 20 1971

ATTEST: William H. Montague
Keeper of The National Register

Date MAR 9 1972

NO
UTM
CD

SEE INSTRUCTIONS

**NATIONAL REGISTER OF HISTORIC PLACES
INVENTORY - NOMINATION FORM**

(Continuation Sheet)

STATE	
North Carolina	
COUNTY	
Lincoln	
FOR NPS USE ONLY	
ENTRY NUMBER	DATE
MAR 24 1972	

(Number all entries)

9.

Sherrill, William T. Annals of Lincoln County North Carolina. Baltimore:
Regional Publishing Company, 1967.

Who's Who in America, Vol. 36. Chicago: A. N. Marquis Company, 1970-1971.



DUPLICATE

72000971

WASO Form - 177
("R" June 1984)

UNITED STATES DEPARTMENT OF THE INTERIOR
NATIONAL PARK SERVICE

NATIONAL REGISTER OF HISTORIC PLACES
EVALUATION/RETURN SHEET

SHADOW LAWN
Lincoln Co.
N.C.

Working No. _____

Fed. Reg. Date: _____

Date Due: _____

Action: ☒ ACCEPT 3-24-72

☐ RETURN

☐ REJECT

Federal Agency: _____

- ☐ resubmission
☐ nomination by person or local government
☐ owner objection
☐ appeal

Substantive Review: ☐ sample ☐ request ☐ appeal ☐ NR decision

Reviewer's comments:

Recom./Criteria _____

Reviewer _____

Discipline _____

Date _____

_____ see continuation sheet

Nomination returned for: _____ technical corrections cited below
_____ substantive reasons discussed below

1. Name

2. Location

3. Classification

Category	Ownership	Status	Present Use
	Public Acquisition	Accessible	

4. Owner of Property

5. Location of Legal Description

6. Representation in Existing Surveys

Has this property been determined eligible? ☐ yes ☐ no

7. Description

Condition

- ☐ excellent
☐ good
☐ fair

- ☐ deteriorated
☐ ruins
☐ unexposed

Check one

- ☐ unaltered
☐ altered

Check one

- ☐ original site
☐ moved date _____

Describe the present and original (if known) physical appearance

- ☐ summary paragraph
☐ completeness
☐ clarity
☐ alterations/integrity
☐ dates
☐ boundary selection

8. Significance

Period Areas of Significance—Check and justify below

Specific dates Builder/Architect

Statement of Significance (*in one paragraph*)

- ☐ summary paragraph
- ☐ completeness
- ☐ clarity
- ☐ applicable criteria
- ☐ justification of areas checked
- ☐ relating significance to the resource
- ☐ context
- ☐ relationship of integrity to significance
- ☐ justification of exception
- ☐ other

9. Major Bibliographical References

10. Geographical Data

Acreage of nominated property _____

Quadrangle name _____

UTM References _____

Verbal boundary description and justification _____

11. Form Prepared By

12. State Historic Preservation Officer Certification

The evaluated significance of this property within the state is:

____ national ____ state ____ local

State Historic Preservation Officer signature

title date

13. Other

- ☐ Maps
- ☐ Photographs
- ☐ Other

Questions concerning this nomination may be directed to _____

Signed _____ Date _____ Phone: _____



NEGATIVE NUMBER N-71-9- 631
PHOTOGRAPHER John Wells
PHOTO DATE Sept 71
SUBJECT Shadow Lawn - Linco/N Co.

NPS Number Mar 24 1972
Title: Shadow Lawn
Loc. Lincoln Cnty, N.C.
Exterior, looking S. E.

PROPERTY OF THE NATIONAL REGISTER

FROM STATE DEPARTMENT OF
ARCHIVES AND HISTORY
RALEIGH, N. C.

DEC 16 1971

PRINT BY NORTH CAROLINA
MUSEUM OF HISTORY

UNITED STATES DEPARTMENT OF THE INTERIOR
NATIONAL PARK SERVICE

NATIONAL REGISTER OF HISTORIC PLACES
PROPERTY MAP FORM

(Type all entries - attach to or enclose with map)

STATE

North Carolina

COUNTY

Lincoln

FOR NPS USE ONLY

ENTRY NUMBER

DATE

MAR 24 1972

1. NAME

Shadow Lawn

COMMON:

AND/OR HISTORIC:

2. LOCATION

STREET AND NUMBER:

301 West Main Street

CITY OR TOWN:

Lincolnton

STATE:

North Carolina

CODE

37

COUNTY:

Lincoln

CODE

109

3. MAP REFERENCE

SOURCE:

State Highway Commission Map of Lincoln County

SCALE: 1"/1 mile

DATE: January 1, 1968

4. REQUIREMENTS

TO BE INCLUDED ON ALL MAPS

1. Property boundaries where required.
2. North arrow.
3. Latitude and longitude reference.

SEE INSTRUCTIONS

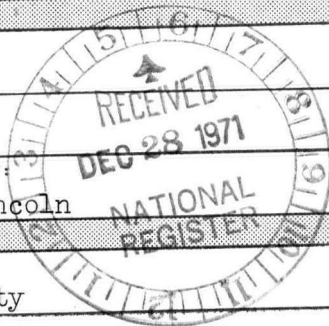

LINCOLNTON N.C.

PH0043168

1122500

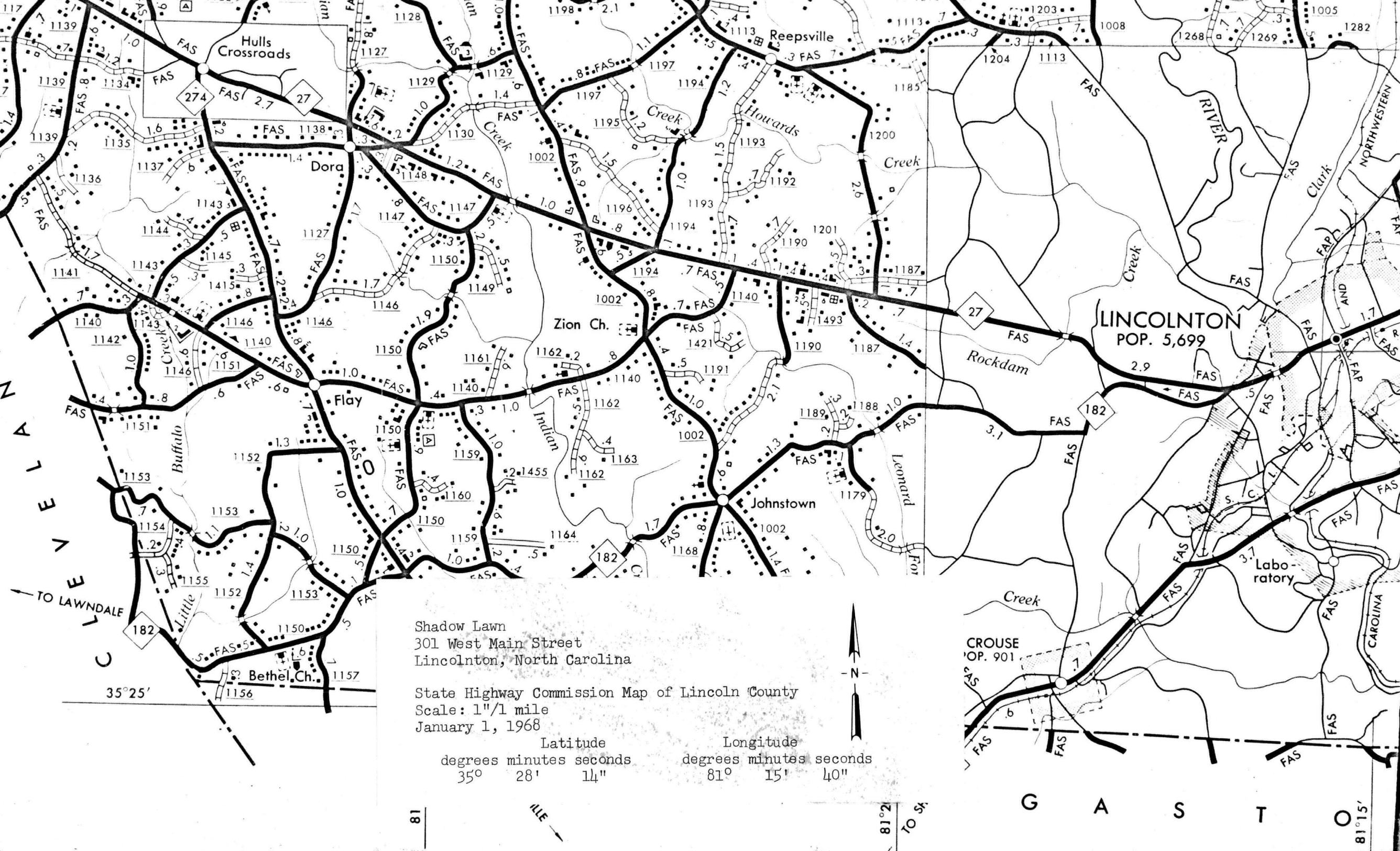



NATIONAL REGISTER OF HISTORIC PLACES
PROPERTY MAP FORM

(Type all entries - attach to or enclose with map)

STATE North Carolina	
COUNTY Lincoln	
FOR NPS USE ONLY	
ENTRY NUMBER	DATE
MAR 24 1972	

SEE INSTRUCTIONS

1. NAME

COMMON: Shadow Lawn
AND/OR HISTORIC:

2. LOCATION

STREET AND NUMBER:

301 West Main Street

CITY OR TOWN:

Lincolnton

STATE:

North Carolina

CODE

37

COUNTY:

Lincoln

CODE

109

3. MAP REFERENCE

SOURCE:

State Highway Commission Map of Lincoln County: Enlarged Municipal Areas

SCALE: 2" / 1 mile

DATE: January 1, 1961

4. REQUIREMENTS

TO BE INCLUDED ON ALL MAPS

1. Property boundaries where required.
2. North arrow.
3. Latitude and longitude reference.



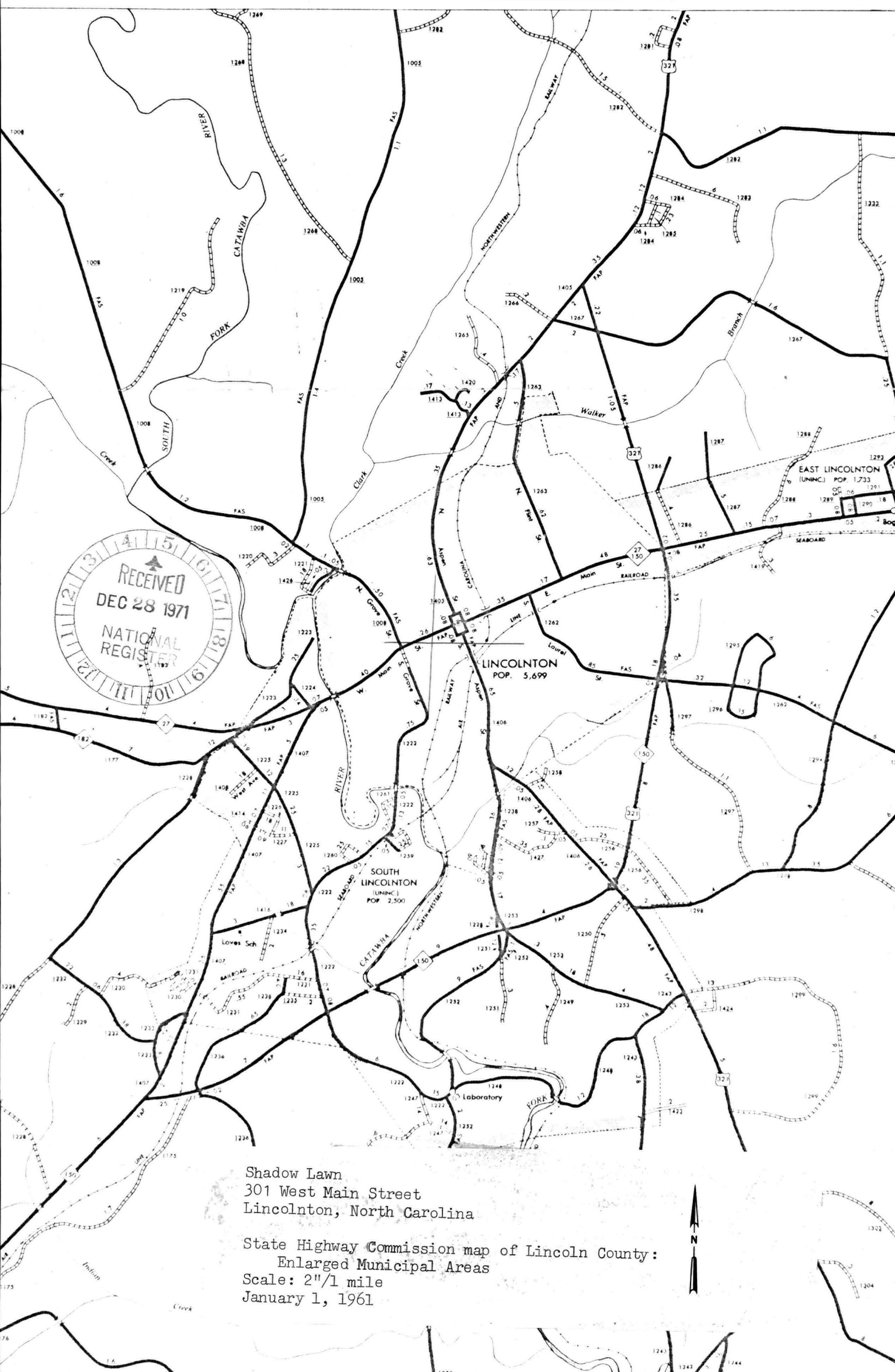

RECEIVED
DEC 28 1971
NATIONAL
REGISTER

Shadow Lawn
301 West Main Street
Lincolnton, North Carolina

State Highway Commission map of Lincoln County:
Enlarged Municipal Areas
Scale: 2"/1 mile
January 1, 1961

State of North Carolina
Department of Archives and History

Raleigh 27602



H. G. JONES
Director

FRED F. HARBIN
Assistant Director

DIVISION ADMINISTRATORS:

C. F. W. COKER
Archives and Records

MRS. JOYE E. JORDAN
Historic Sites and Museums

MRS. MEMORY F. MITCHELL
Publications

8 December 1971

Dr. William J. Murtagh
Keeper of the National Register
National Park Service
801 19th Street, N.W.
Washington, D.C. 20006



Dear Dr. Murtagh:

We are enclosing a nomination for Shadow Lawn in Lincoln County, North Carolina, to be entered in the National Register of Historic Places.

We trust you will find this nomination in order. If there are any questions, please call us.

Sincerely yours,

A handwritten signature in cursive script, appearing to read "H. G. Jones".

H. G. Jones
Liaison Officer

enclosures

ENTRIES IN THE NATIONAL REGISTER

STATE NORTH CAROLINA

Date Entered MAR 24 1972

<u>Name</u>	<u>Location</u>
Stanly (Edward R.) House	New Bern Craven County
Harmony Hall	White Oak vicinity Bladen County
St. Paul's Roman Catholic Church	New Bern Craven County
The Bryan House and Office	New Bern Craven County
The Barker House	Edenton Chowan County
First Baptist Church	New Bern Craven County
St. John's Episcopal Church	Rutherfordton Rutherford County
Shadow Lawn	Lincolnton Lincoln County
Holly Bend	Huntersville Mecklenburg County

Also Notified

Hon. Sam J. Ervin, Jr.	State Liaison Officer
Hon. B. Everett Jordan	Dr. H. G. Jones
Hon. Walter B. Jones	Director
Hon. Alton Lennon	Department of Archives & History
Hon. Roy Taylor	State of North Carolina
Hon. Charles R. Jones	Post Office Box 1881
	Raleigh, North Carolina 27602
Director, Southeast Region	

HR NRowland:mmm