



Lincoln County Planning & Inspections

Single Family Residential Patio Covers & Carports

How to Use this Guide

Check with your jurisdiction regarding type of submittal (paper or electronic) and for additional requirements. Draw to scale and complete the following (hint: use graph paper with $\frac{1}{4}$ " squares. Example: $\frac{1}{4}$ " = 1').

1 Complete this Building Guide by filling in the blanks on page two, and indicating which construction details will be used.

2 Provide 2 Plot Plans (site plan) showing dimensions of your project or addition and its relationship to existing buildings or structures on the property and the distance to existing property lines drawn to scale. See Page 2

3 Fill out a building permit application.

The majority of permit applications are processed with little delay. The submitted documents will help determine if the project is in compliance with building safety codes, zoning ordinances and other applicable laws.

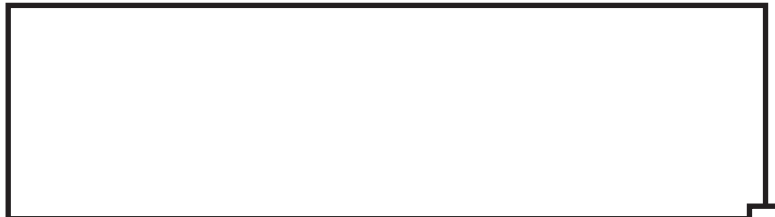
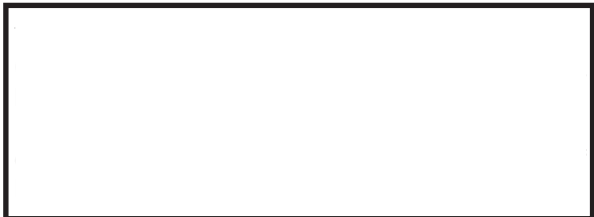
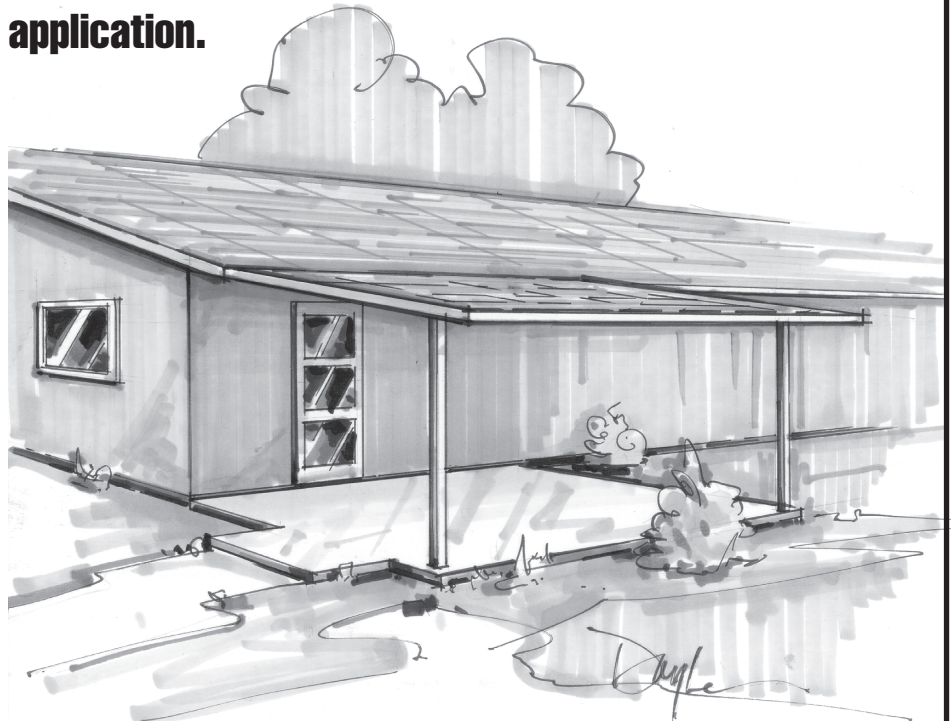

Single Family Residential Patio Covers & Carports

Site Plan Example

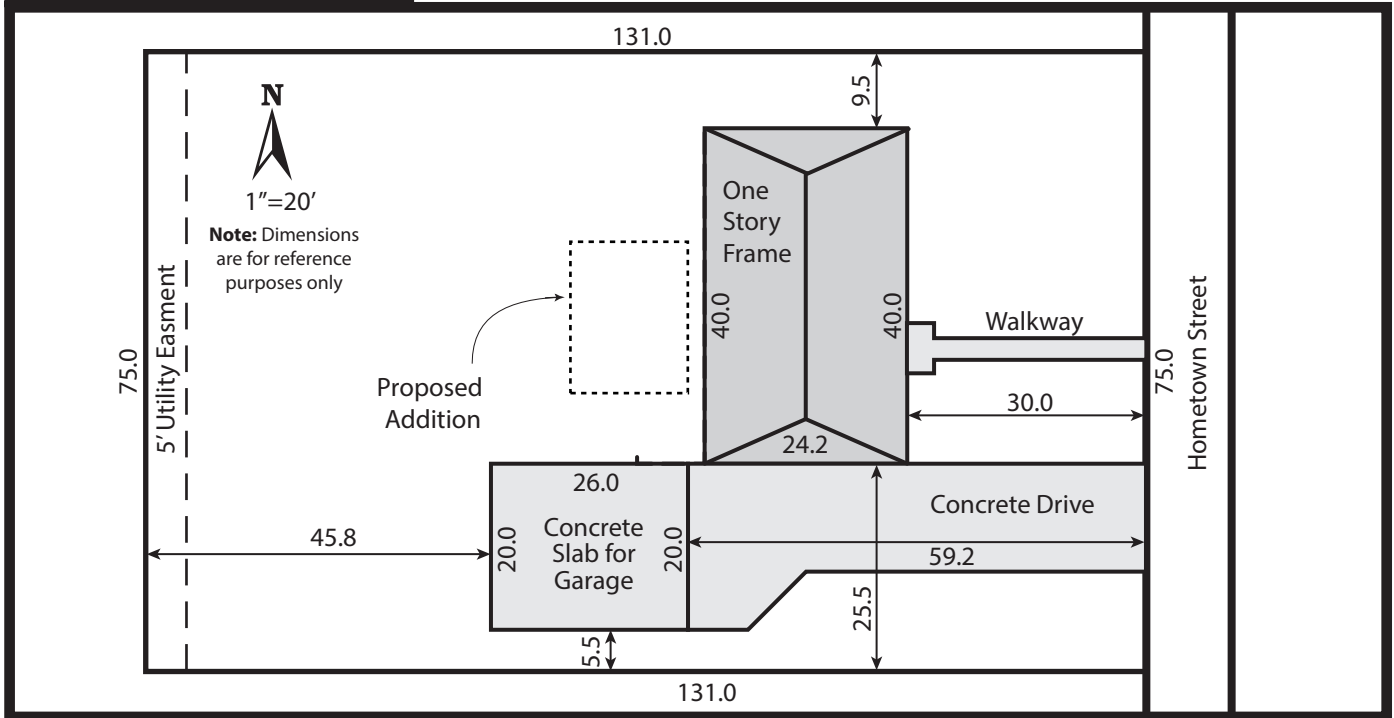

Note: Manufactured homes require independent/self supported patio structure

Single Family Residential Patio Covers & Carports

Directions

Address: _____

1. Fill in the blanks with dimensions and materials which will be used to build the structure. Please print legibly.
2. Indicate in the check boxes which details from page 4 will be used. Please note if any of the sides of your carport addition are closer than 5'-0" to the property line, that side of the carport must be enclosed with a solid 1 hour fire rated wall as shown in Alternate Details B and C. You must however, keep at least two sides of the carport open to conform to the building code requirements. Zoning approval is required.
3. Roofing to be installed per manufacturer's instructions, including low slope application and required inspections made.

Roof covering _____
(example: Class A 3 tab shingles)

Underlayment _____
(example: 15# felt with 19" laps)

Size and Amount of Lags _____
(example: Two 1/2"x 4 1/2" lags @ 16" O.C.)

12 pitch _____

Sheathing _____
(example: 1/2" exterior plywood)

2x _____ rafters spaced _____" O.C.
(example: 2 x 8 rafters spaced 24" O.C.)

Patio Section

Existing building

Span

Maximum rise 7 3/4" to top of door threshold

Slope

Concrete Slab

Isolate from Slab

Minimum Diameter Pier 8" (size determined by load)

Overhang

Note: Walls, posts, and overhangs closer than 5' to the property line to be 1hr. rated

No closer than 2 feet to property line

Beam splices to occur over posts with 1 1/2" bearing

() "x ()" beam
(example: (2) 2"x10")

Span _____
(example: 12' 0")

Siding _____
(for Alternate B only)

"x" posts spaced _____ apart
(example: 4"x4" spaced 6')

Footing "x" _____
(for Alternate C only)

Check one
☐ Detail A
☐ Alternate A
☐ Other (provide detail) (see page 4)

Check one
☐ Detail B
☐ Alternate B (see page 4)

Check one
☐ Detail C
☐ Alternate C (see page 4)

Single Family Residential Patio Covers & Carports

Detail A

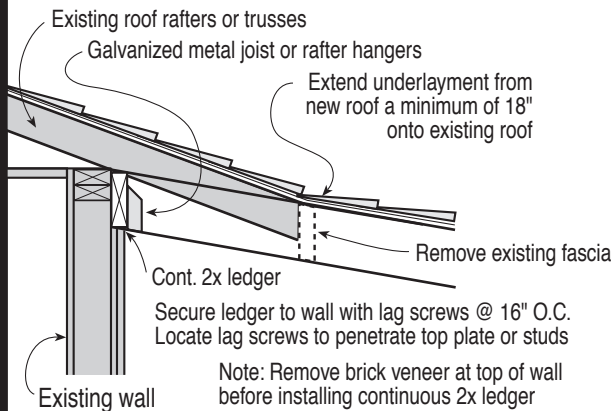

Alternate Detail A

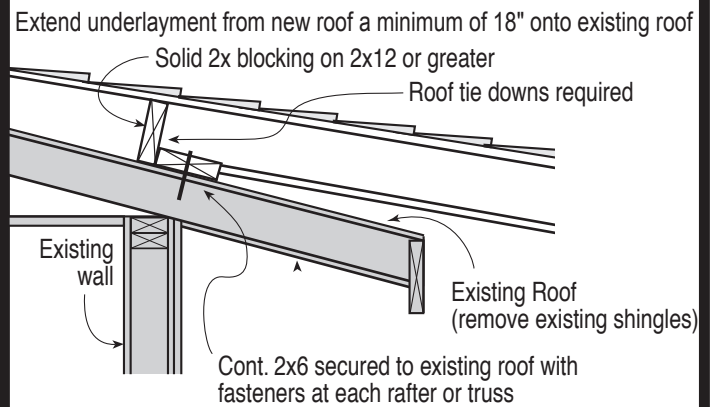

Detail B

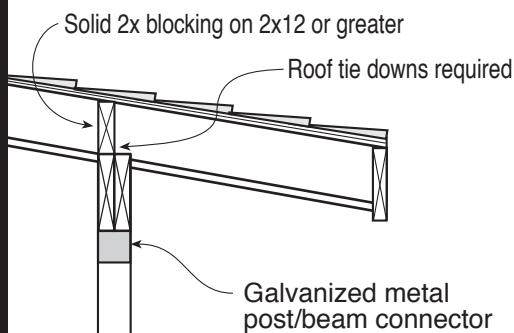

Alternate Detail B - 1 Hour Wall

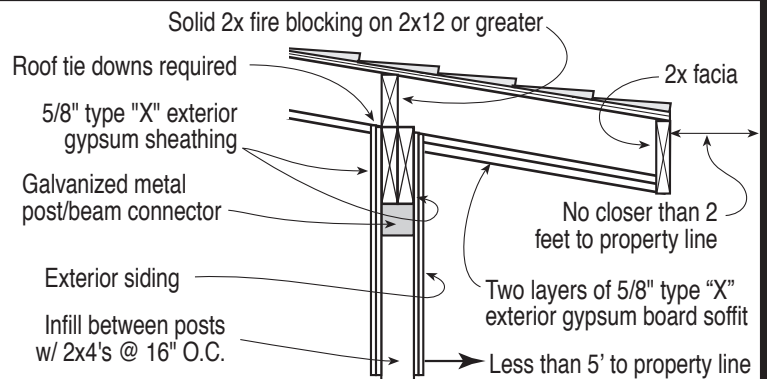

Detail C

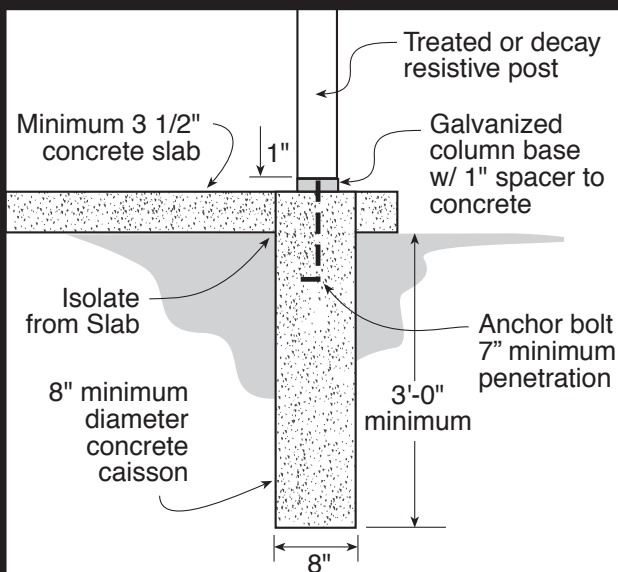

Alternate Detail C - 1 Hour Wall

